

OWNER'S MANUAL

PED SERIES

1/3 & 1/2 HP

Pedestal Sump Pumps



CONTENTS:

General Safety	1
Applications & Specifications	2
Pre-Installation & Assembly	3
Installation	4
Operation, Care/Cleaning & Parts	5
Troubleshooting	6
Warranty	7

BEFORE YOU START

A sump pump is an electrical device designed to operate in inherently wet environments.

ALWAYS USE EXTREME CAUTION when installing or maintaining this product.

IMPORTANT SAFETY INSTRUCTIONS

Carefully read and follow all safety instructions in this manual and on pump.

SAVE THESE INSTRUCTIONS – This manual contains important instructions that should be followed during installation, operation, and maintenance of the product.

Save this manual for future reference.

Safety Labels

 This is the safety alert symbol. When you see this symbol on your pump or in this manual, look for one of the following signal words and be alert to the potential for personal injury!

 **DANGER** Indicates a hazard which, if not avoided, will result in death or serious injury.

 **WARNING** Indicates a hazard which, if not avoided, could result in death or serious injury.

 **CAUTION** Indicates a hazard which, if not avoided, could result in minor or moderate injury.

NOTICE indicates practices not related to personal injury.

Keep safety labels in good condition. Replace missing or damaged safety labels.

General Safety

 **CAUTION** Risk of burns. Do not touch an operating motor. Motors are designed to operate at high temperatures. To avoid burns when servicing pump, allow it to cool for 20 minutes after shut-down before handling.

Do not allow pump or any system component to freeze. To do so will void warranty.

Pump water only with this pump.

Periodically inspect pump and system components.

Wear safety glasses at all times when working on pumps.

APPLICATIONS

Ideal for High-Volume Water Removal from Basement Sump Pits

SPECIFICATIONS

Model	HP	Volt	Ph	Amps	Capacity (GPH at 0')	Max Head	Construction	Impeller	Cord Length	Solids Pumped
EPP33	1/3	120	1	4.0	3600	18'	Thermoplastic	Thermoplastic	8'	3/16"
EPC33	1/3	120	1	4.0	3600	18'	Cast Iron	Thermoplastic	8'	3/16"
EPP50	1/2	120	1	5.2	5000	22'	Thermoplastic	Nylon	8'	3/8"
EPC50	1/2	120	1	5.2	5000	22'	Cast Iron	Nylon	8'	3/8"

EPP THERMOPLASTIC BASE

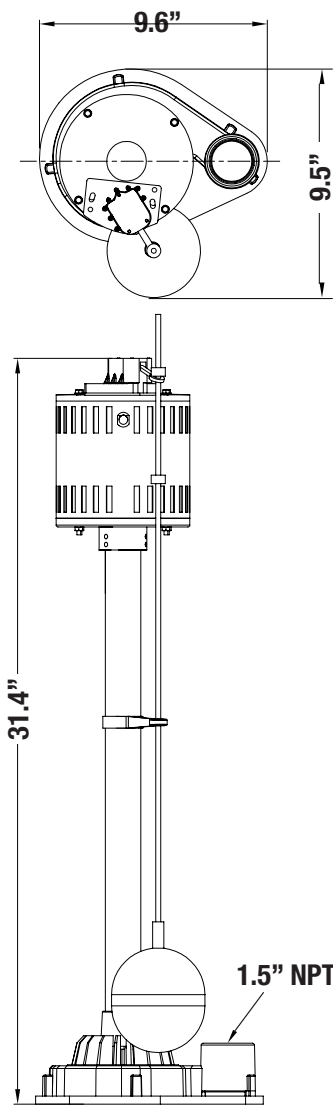

EPC CAST IRON BASE

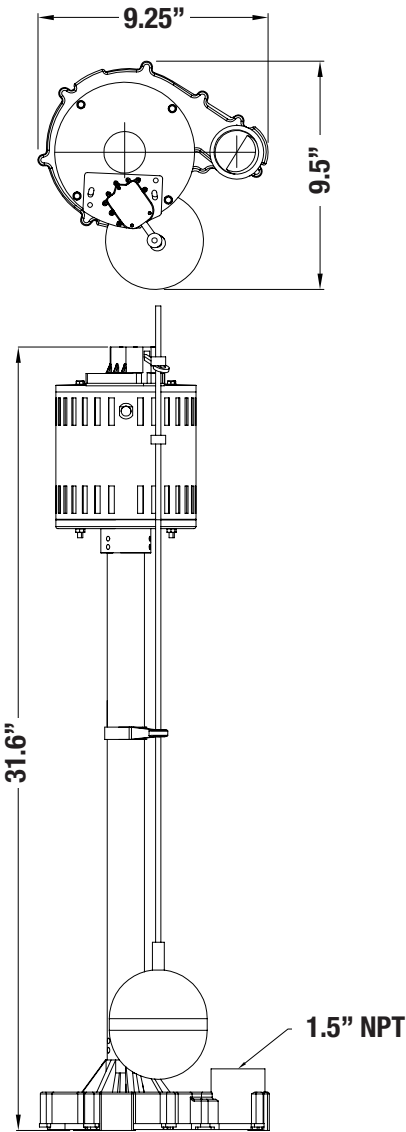

PRE-INSTALLATION

BEFORE FIRST USE

Carefully examine the pump and all parts to ensure no parts are damaged. If any part of the pump appears to be damaged, do not use the pump and contact the **Customer Service Team at 1-877-326-3561**.

INTENDED USE

This pump is suitable to pump rain water and also can be used both for permanent and temporary installation. The pump can be placed in a sump pit to pump rain water containing suspended solid particles 3/8 in. for EPC33 & EPC50 and 3/16 in. for EPP33 & EPP50 or less in diameter.

INSTALLATION REQUIREMENTS

Call an electrician when in doubt. Pump should be connected to a separate 15 amp circuit breaker or 15 amp fuse block. Note that plugging into existing outlets may cause low voltage at the motor. This could cause blown fuses, tripping of the motor, overload or burned-out motor.

This pump is provided with an on/off float switch for automatic operation. Refer to the Installation instructions included with switches and controllers for installation.

Care should be taken to prevent the pump from running in a dry sump.

Plastic PVC pipe can be installed in the outlet piping. Drain hose, galvanized steel or copper pipe may be used if desired. All piping must be clean and free of all foreign matter to prevent clogging.

Before installing the pump, clear the sump basin of any water, debris, or sediment.

PACKAGE CONTENTS

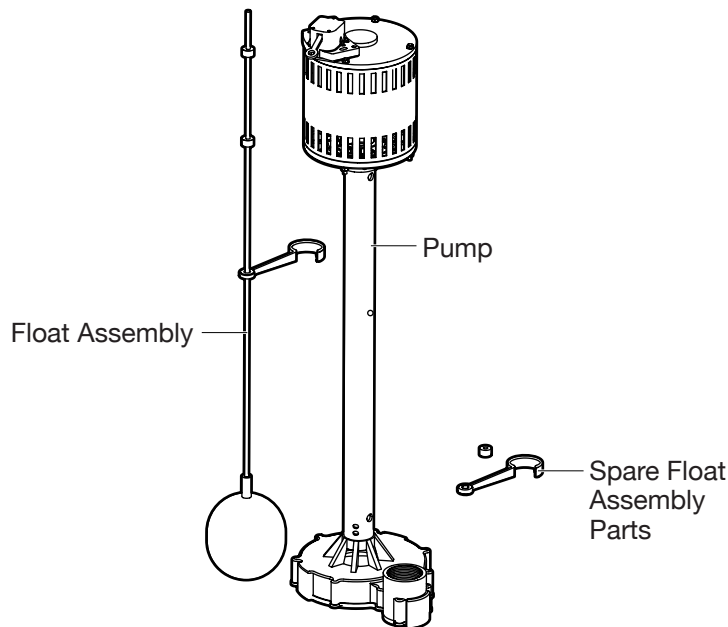

MATERIALS REQUIRED (NOT INCLUDED)

Before using this pump, ensure you have the following items: Inlet and discharge piping, Thread sealant tape, Check valve, PVC glue and Sump basin

ASSEMBLY

1 PREPARING THE PUMP

Remove the upper rubber grommet (1) from the float assembly (B).

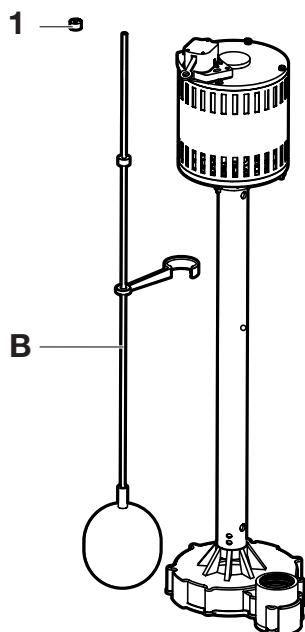

2 ATTACHING FLOAT ASSEMBLY

Insert the top of the float assembly (B) in the switch arm hole. Slide the upper rubber grommet (1) over the end of the float assembly (B) to hold the float assembly in place. Adjust the float assembly per the dimensions in step 3.

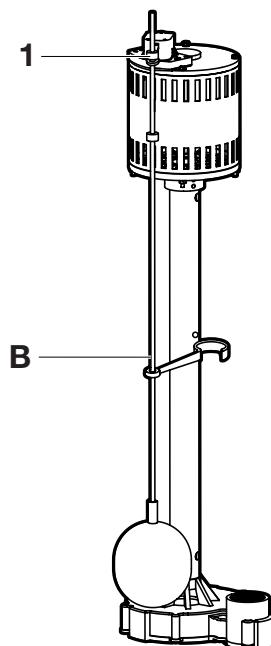

3 ADJUSTING THE FLOAT ASSEMBLY

- Install the bracket (1) to the hole on the column (A). Ensure the pin on the bracket (1) is inserted in the hole on the column (A).
- Adjust the lower rubber grommet's position (control switch ON). The grommet (2) should be between 5.5 in. and 9 in. from the top of the rod.

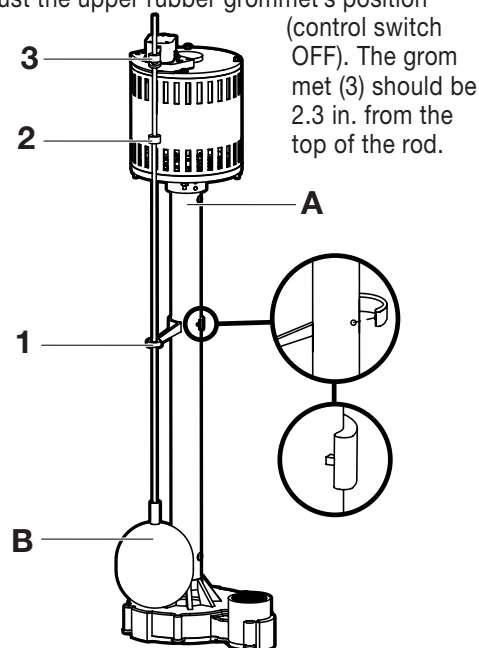

INSTALLATION

1 PREPARING THE PUMP BASIN

- The pump must be installed in a suitable basin (not included). The basin must be a maximum of 24 in. deep and at least 11 in. wide for pumps fitted with vertical on/off switches.

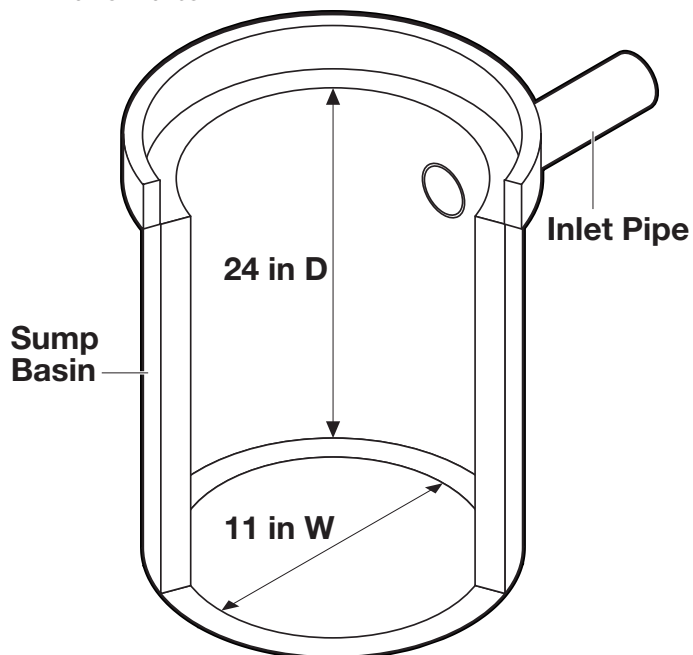

2 PLACING THE PUMP IN A BASIN

- Place the pump (A) on a hard surface inside the sump basin. Ensure the surface is clear of debris.
- Never place the pump on clay, earth, or gravel surfaces. It is recommended that the pump be placed on two bricks (not included) approximately 2 in. apart.

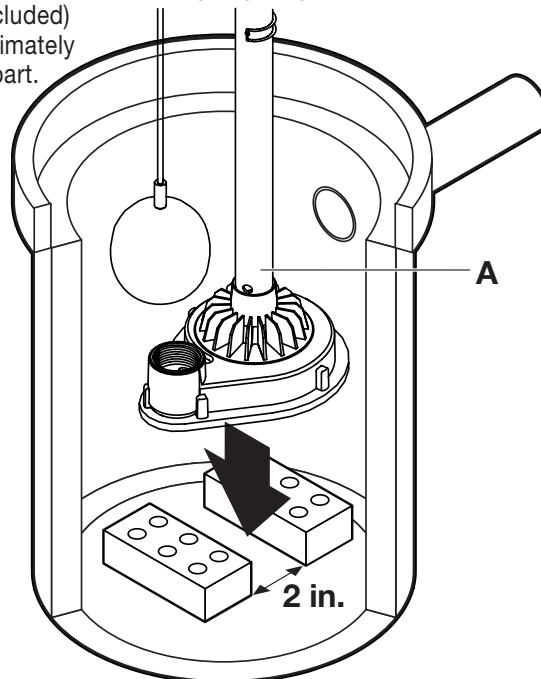

3 CONNECTING THE PIPE AND FITTINGS

- Connect the discharge pipe, fittings, and check valve (not included) to the discharge port of the pump.

NOTE It is recommended that the discharge pipe diameter be equal to or larger than the discharge size of the pump.

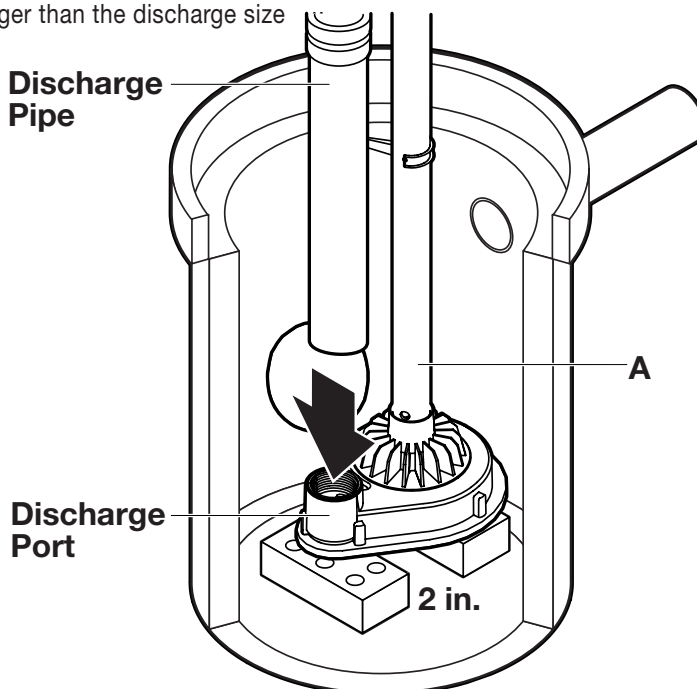

OPERATION

1 CONNECTING POWER AND TESTING PUMP OPERATION

- Plug the pump power cord into 120V GFCI power outlet.

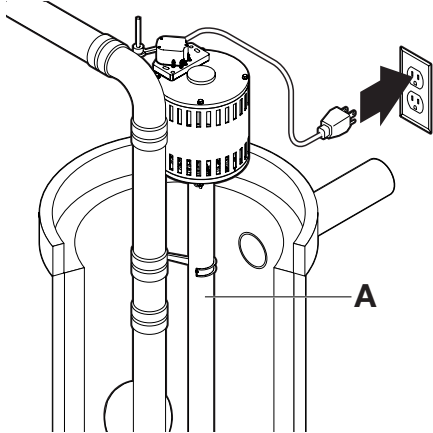

2 OPERATING THE PUMP

- The pump will start automatically when the water level raises to the appropriate depth to activate the switch. To test the pump, pour water into the sump until the pump activates.

NOTE It is recommended that the discharge pipe diameter be equal to or larger than the discharge size of the pump.

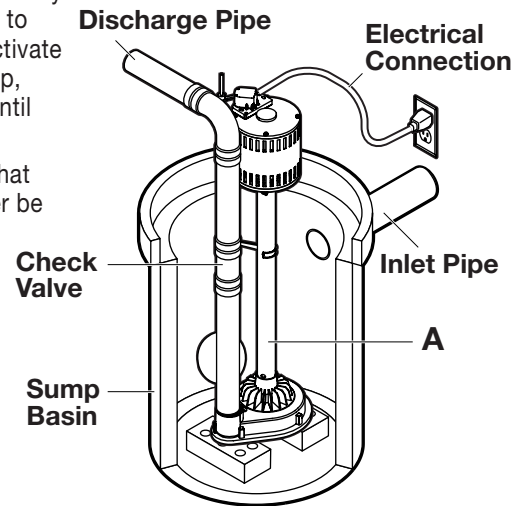

CARE AND CLEANING

⚠ WARNING Ensure the pump is disconnected from the power source before attempting to service or remove any component.

To clear a pump that is clogged with debris:

- Unplug the pump to disconnect the electrical power
- Unscrew the screws (1).
- Remove the base.
- Remove any debris from around the impeller (3).
- Reassemble the pump.

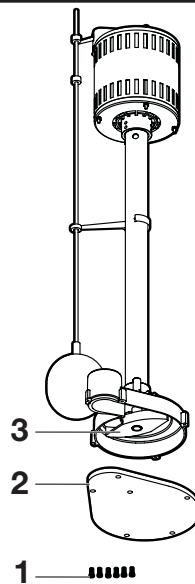

ADDITIONAL MAINTENANCE GUIDELINES

- Disassembly of the motor prior to expiration of warranty will void the warranty. If repairs are required, see the Troubleshooting chart.
- The inlet should be kept clean and free of all foreign objects and inspected annually. A clogged inlet will damage the pump.
- The pump should be checked monthly for proper operation.

REPLACEMENT PARTS

Number	Description	Part Number
1	Basew/screws - EPP	091PED014
2	Float rod retainer	091PED007
3	Float washer	091PED010
4	On/Off Switch	091PED005

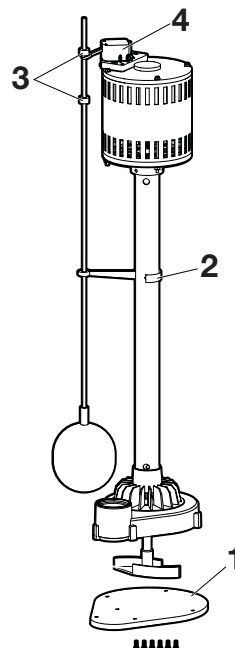

TROUBLESHOOTING

PROBLEM	POSSIBLE CAUSE	CORRECTIVE ACTION
THE PUMP DOES NOT RUN.	<ol style="list-style-type: none"> 1. The line circuit breaker is off, or fuse is blown or loose 2. Water level in the sump has not reached turn-on level as indicated in the installation drawing. 3. Pump cord is not making contact in the receptacle. 4. The float is stuck. 	<ol style="list-style-type: none"> 1. Reset the breaker or replace the fuse. If the problem continues, contact a plumbing professional. 2. The pump will turn on when water level reaches the appropriate depth for your switch type. 3. Replug the pump cord. 4. Ensure the float operates freely in the basin.
THE PUMP RUNS BUT DOES NOT DELIVER WATER.	<ol style="list-style-type: none"> 1. Check if the valve is installed backward. 2. Discharge shut-off valve (if used) may be closed. 3. The impeller or volute openings are fully or partially clogged. 4. The pump is air-locked. 5. Inlet holes in the pump base are clogged. 6. The vertical pumping distance is too high. 	<ol style="list-style-type: none"> 1. The arrow on the valve should point in the direction of the flow. 2. Open the shut-off valve. 3. Remove the pump and clean. 4. Start and stop several times by plugging and unplugging the cord. Check for a clogged vent hole in pump case. 5. Remove the pump and clean the openings. 6. Reduce the distance or change the discharge fittings of the pump.
THE PUMP RUNS AND PUMPS OUT SUMP, BUT DOES NOT STOP.	<ol style="list-style-type: none"> 1. The pump is air-locked. 2. Vertical pumping distance is too high. 3. Inlet holes in the pump base are clogged. 4. The impeller or volute openings are fully or partially clogged. 5. Pump impeller is partially clogged with tar or paint, causing the motor to run slow and overload. 6. Float is stuck in the ON position. 	<ol style="list-style-type: none"> 1. Start and stop several times by plugging and unplugging the cord. Check for a clogged vent hole in the pump case. 2. Reduce the distance or change the discharge fitting of the pump. 3. Remove the pump and clean the strainer and openings. 4. Remove the pump and clean. 5. Remove the pump and clean. 6. Ensure the float operates freely in the basin. Check for a clogged vent hole in the pump case.
THE FUSE BLOWS OR CIRCUIT BREAKER TRIPS WHEN THE PUMP STARTS.	<ol style="list-style-type: none"> 1. The pump impeller is partially clogged causing the motor to run slow and overload. 2. The fuse size or circuit breaker may be 3. The impeller or volute opening are fully or partially clogged. 4. Pump is not on a dedicated electrical circuit. 	<ol style="list-style-type: none"> 1. Remove the pump and clean. 2. The fuse must be 15 amps. 3. Remove the pump and clean. 4. Remove other devices from electrical circuit.
THE MOTOR RUNS FOR A SHORT TIME, THEN STOPS.	<ol style="list-style-type: none"> 1. Inlet holes in the pump base are clogged. 2. The pump impeller is partially clogged causing the motor to run slow and overload. 3. The impeller or volute openings are fully or partially clogged. 	<ol style="list-style-type: none"> 1. Remove the pump and clean the openings. 2. Remove the pump and clean. 3. Remove the pump and clean. Also clean the strainer if one is installed.

ELECTRICAL PRECAUTIONS



WARNING Before servicing a pump, always shut off the main power breaker and then unplug the pump. Make sure you are not standing in water and are wearing insulated protective sole shoes, under flooded conditions. Contact your local electric company or a qualified licensed electrician for disconnecting electrical service prior to pump removal

WARRANTY

Retain Original Purchase Receipt for Warranty Eligibility

Limited Warranty

Manufacturer warrants to the original consumer purchaser ("Purchaser" or "You") that its products are free from defects in material and workmanship for the period indicated on package of purchased pump. The warranty indicated on the package is from the date of the original consumer purchase. If, within the warranty indicated on the package from the original consumer purchase, any such product shall prove to be defective, it shall be repaired or replaced at manufacturer's option, subject to the terms and conditions set forth herein. Note that this limited warranty applies to manufacturing defects only and not to ordinary wear and tear. All mechanical devices need periodic parts and service to perform well. This limited warranty does not cover repair when normal use has exhausted the life of a part or the equipment.

The original purchase receipt and product warranty information label are required to determine warranty eligibility. Eligibility is based on purchase date or original product – not the date of replacement under warranty. The warranty is limited to repair or replacement of original purchased product only, not replacement product (i.e. one warranty replacement allowed per purchase).

The original purchase receipt and product warranty information label are required to determine warranty eligibility. Eligibility is based on purchase date or original product – not the date of replacement under warranty. The warranty is limited to repair or replacement of original purchased product only, not replacement product (i.e. one warranty replacement allowed per purchase).

Purchaser pays all removal, installation, labor, shipping, and incidental charges.

Claims made under this warranty shall be made by returning the product to the retail outlet where it was purchased or to the factory immediately after the discovery or any alleged defect. Manufacturer will subsequently take corrective action as promptly as reasonably possible. No requests for service will be accepted if received more than 30 days after the warranty expires. Warranty is not transferable and does not apply to products used in commercial/rental applications.

General Terms and Conditions; Limitations of Remedies

You must pay all labor and shipping charges necessary to replace product covered by this warranty. This warranty does not apply to the following: (1) acts of God; (2) products which, in manufacturer's sole judgment, have been subject to negligence, abuse, accident, misapplication, tampering, or alteration; (3) failures due to improper installation, operation, maintenance or storage; (4) atypical or unapproved application, use or service; (5) failures caused by corrosion, rust or other foreign materials in the system, or operation at pressures in excess of recommended maximums.

This warranty sets forth manufacturer's sole obligation and purchaser's exclusive remedy for defective products.

MANUFACTURER SHALL NOT BE LIABLE FOR ANY CONSEQUENTIAL, INCIDENTAL, OR CONTINGENT DAMAGES WHATSOEVER. THE FOREGOING LIMITED WARRANTIES ARE EXCLUSIVE AND IN LIEU OF ALL OTHER EXPRESS AND IMPLIED WARRANTIES, INCLUDING BUT NOT LIMITED TO IMPLIED WARRANTIES OF MERCHANTABILITY AND FITNESS FOR A PARTICULAR PURPOSE. THE FOREGOING LIMITED WARRANTIES SHALL NOT EXTEND BEYOND THE DURATION PROVIDED HEREIN.

Some states do not allow the exclusion or limitation of incidental or consequential damages or limitations on how long an implied warranty lasts, so the above limitations or exclusions may not apply to You. This warranty gives You specific legal rights and You may also have other rights which vary from state to state.



1899 Cottage Street, Ashland, Ohio 44805

Telephone: 1-877-326-3561

Fax: 1-877-326-1994

www.ecofloproducts.com

Copyright © 2020, ECO-FLO PRODUCTS, INC.
EF-0064/PEDOM-rev. 04/2020